

Technical Data Sheet

Drum pumps F 426



More than just pumps

Drum pumps F 426

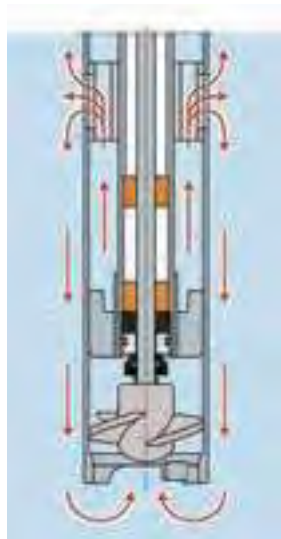

Advantages/characteristics:

- ▶ For mixing and/or conveying inhomogeneous fluids
- ▶ Two control levers to easily open/close the mixing openings
- ▶ Mixing openings allow backflow of the media for mixing back in the container
- ▶ With mechanical seal for inner tube seal
- ▶ 3 operating modes in one pump: Conveying, conveying with simultaneous mixing, also temporary mixed operation
- ▶ Switching operating modes is possible while operating
- ▶ Easy to dismantle for cleaning
- ▶ Distinct feature: The inner tube is reinforced with a metal core on the PP-version
- ▶ Temporary operation against closed valve (e.g. hand nozzle) is possible (until the indicated max. operating temperature has been reached)



Technical data/type	F 426 PP	F 426 S
Seal type		Mechanical seal
Version		With impeller for max. flow rate
Pressure-side connection		Thread G 1 1/4 A
Materials		
Pump	Polypropylene	Stainless steel 316 Ti
O-ring ²⁾	FKM	FKM
Mechanical seal	Oxide ceramics, PTFE/coal, O-ring FKM	
Shaft	Hastelloy C	Stainless steel
Impeller		ETFE
Dimensions		
Outer tube diameter / Impeller diameter (mm)	50/33	41/38
Standard immersion depth (mm)	1 000, 1 200, 1 500	
Other immersion depths / special lengths (mm) ³⁾	500 - 2 000	
Operating range		
Container	Drums, IBCs, tanks, canisters, hobbocks, mixing containers etc.	
Media temperature (°C)	0 to +50	0 to +100
Media temperature ex-application (°C)	-	0 to +40
Ambient temperature (°C)	0 to +40	-20 to +40
Weight Ø 41, ID 1 000 mm (kg)	-	3.8
Weight Ø 50, ID 1 000 mm (kg)	1.8	-
Certificates		
Ex-identification	None	II 1/2 G c IIB T4
Silicone-free version		On request
Performance data¹⁾		
	Axial impeller	
Flow rate max. l/min.	240	
Delivery head max. mwc	13	
Viscosity max. mPas	1.200	800

1) Dependent on pump version, medium and motor

2) Other materials on request

3) In gradations of 100 mm

Design, function and dimensions

Drum pumps F 426

Design:

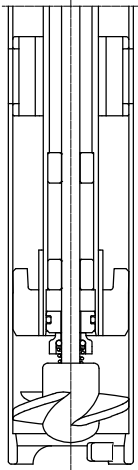

F 426 with mechanical seal and axial impeller

Function:

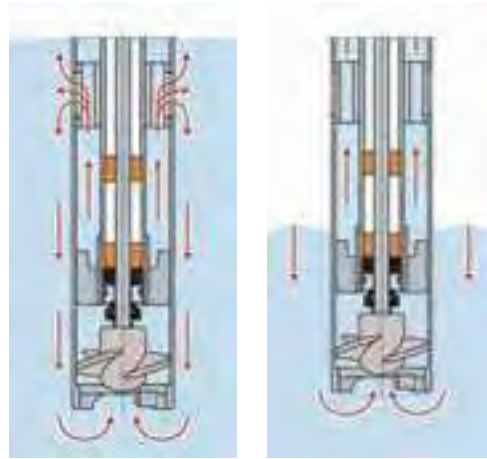

F 426 with open mixing openings (mixing) and closed mixing openings (pumping)

Dimensions:

Drum pump F 426

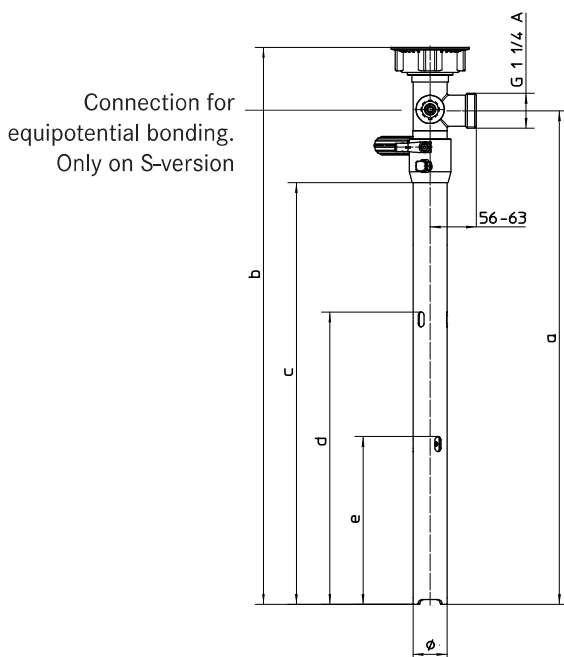

Drum pump with motor

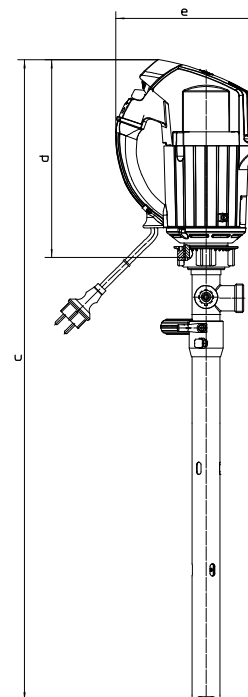

Immersion depths (ID)

Pump material	Ø (mm) Outer tube/ impeller	ID (mm)	ID (mm)				
			a	b	c	d	e
PP	50/33	1 000	1 116	1 191	1 026	407	337
		1 200	1 316	1 391	1 226	407	337
		Other	ID + 116	ID + 191	ID + 26	407	337
S	41/38	1 000	1 106	1 181	1 018	352	202
		1 200	1 306	1 381	1 218	352	202
		Other	ID + 106	ID + 181	ID + 18	352	202

F 426 with motor

Motor type	c (mm)	d (mm)	e (mm)
FEM 4070	b + d - 16	207	186
F 457 (EL)		225	217
F 458 (-1, EL)		292	209
F 460 Ex (-1, EL)		292	209
FBM 4000 Ex		292	209
F 416 Ex		119	230
F 416-1 Ex		101	120
F 416-2 Ex		101	120

Performance diagrams¹⁾ & part numbers

Drum pumps F 426

The following performance diagrams apply to the indicated impellers and motors, for all pump materials respectively.

Axial impeller Ø 33

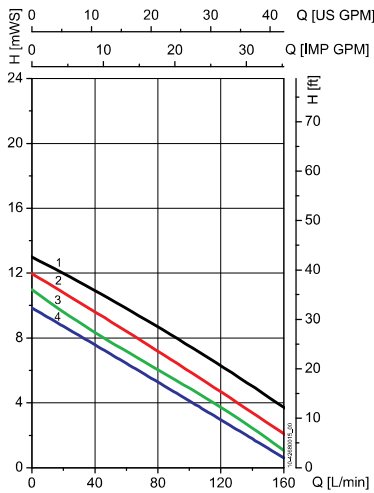

- 1) F 416 Ex, F 416-1 Ex, F 416-2 Ex (6 bar)
- 2) F 457, F 457 EL, F 458-1, F 460-1 Ex
- 3) FBM 4000 Ex
- 4) FEM 4070, F 458, F 458 EL, F 460 Ex, F 460 Ex EL

Axial impeller Ø 38

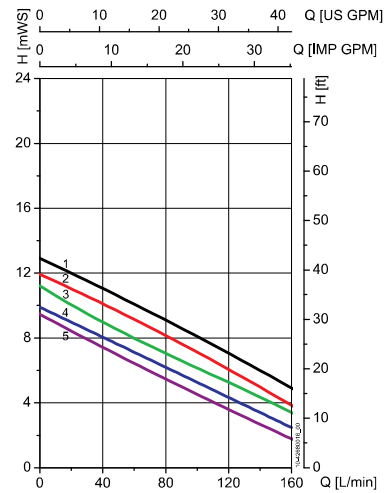

- 1) F 416 Ex, F 416-1 Ex, F 416-2 Ex (6 bar)
- 2) F 457, F 457 EL, F 458-1, F 460-1 Ex
- 3) FBM 4000 Ex
- 4) FEM 4070
- 5) F 458, F 458 EL, F 460 Ex, F 460 Ex EL

Part numbers:

Standard immersion depths								
Type	Material			Diameter (mm)		Part no.		
	Pump	Shaft	O-ring	Ø outer tube	Ø impeller	1 000 mm	1 200 mm	1 500 mm
F 426 Connection thread G 1¼ A	PP	HC	FKM	50	33	10-426 40 001	10-426 40 002	10-426 40 003
			FKM	41	38	10-426 20 010	10-426 20 012	10-426 20 015
	S	S	FFKM			10-426 29 010	10-426 29 012	-

Other immersion depths/other O-rings/other connections on request

Hose connections with union nut G 1¼						
Connection	Material	Union nut	Size			
			DN 13	DN 19	DN 25	DN 32
Polypropylene (PP)	PP	PP	10-959 04 081	10-959 04 053	10-959 04 052	10-959 04 054
Stainless steel (S) 316 Ti	Brass nickel-plated	Brass nickel-plated		10-959 04 061	10-959 04 041	10-959 04 042
Stainless steel (S) 316 Ti	S	S		10-959 04 062	10-959 04 063	10-959 04 064

1) Determined with water at 20 °C, measured values ± 10 % maximum flow rate with open discharge outlet

Accessories

Drum pumps F 426

Accessories for drum pump F 426

Compatible with drum pumps from the F 426 series, we offer a wide selection of accessories, for example, compression glands, hoses, hand nozzles. More information can be found in the FLUX accessory brochure, in the price list or on our homepage: www.flux-pumps.com.

- for use in hazardous areas
- for use in hazardous and non hazardous areas
- for use in non hazardous areas

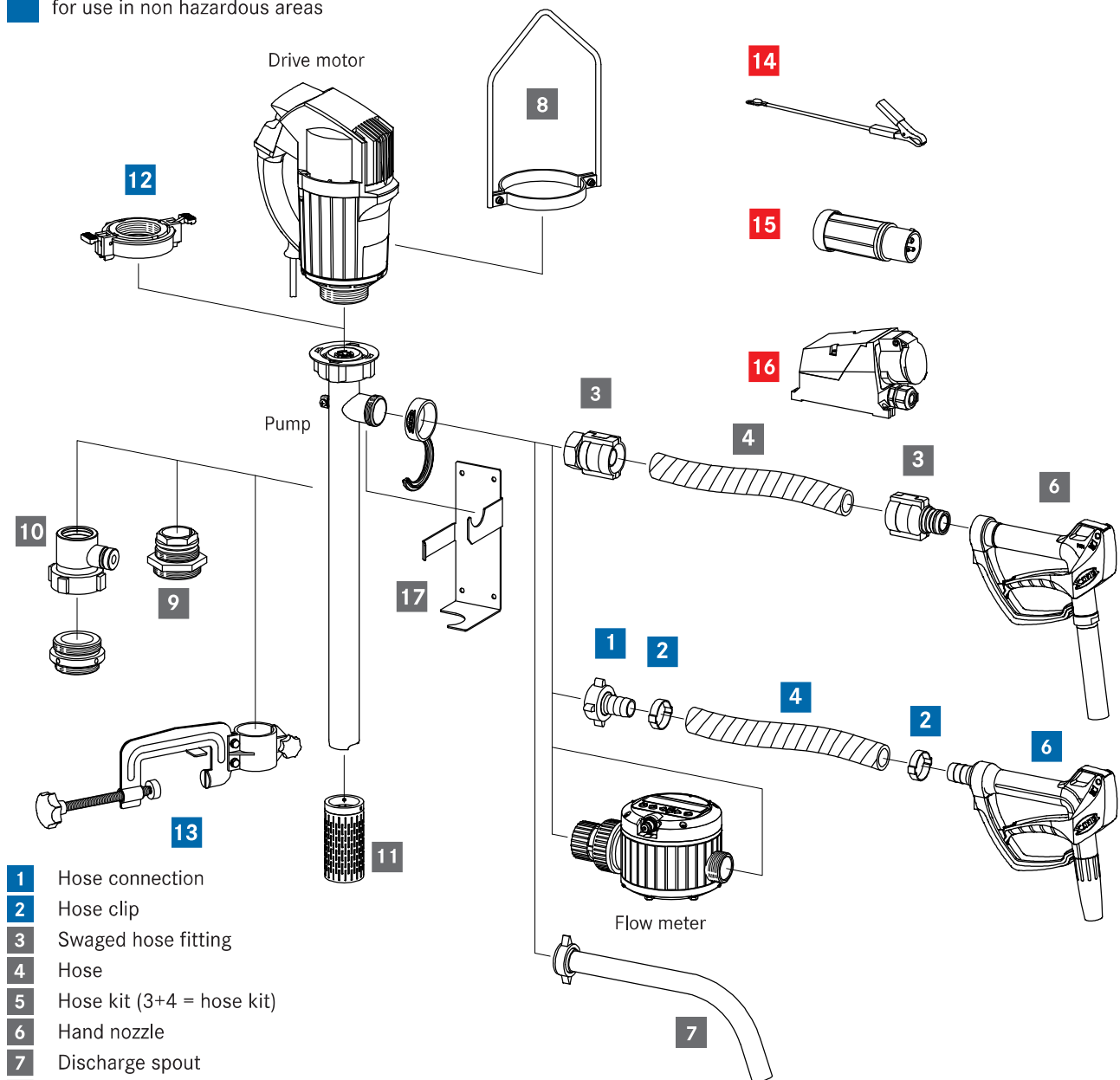

- 1 Hose connection
- 2 Hose clip
- 3 Swaged hose fitting
- 4 Hose
- 5 Hose kit (3+4 = hose kit)
- 6 Hand nozzle
- 7 Discharge spout
- 8 Carrying handle
- 9 Compression gland
- 10 Fume gland
- 11 Suction strainer
- 12 Quick action coupling
- 13 Attachment clamp
- 14 Earth (ground) wire
- 15 Explosion-proof plug
- 16 Explosion-proof socket
- 17 Wall bracket

FLUX-GERÄTE GMBH

Talweg 12 · D-75433 Maulbronn

Tel +49 7043 101-0 · Fax +49 7043 101-444

info@flux-pumpen.de · www.flux-pumps.com