



## THERMOPLASTIC MAG-DRIVE ROTARY VANE PUMPS



### SYSTEM PRESSURE

5 bar.

### STANDARD

- High torque magnetic coupling.
- Direct starting motor.

### OPTIONAL

- Flanges available (DIN or ANSI).
- Dry-running protection device.
- Baseplate.
- Available in ATEX version for zone 2 II3G (pump mod. EM-P PP/PVDF).

### MAIN FEATURES

Mag drive rotary vane pumps series HPP-HPF are made of thermoplastic materials (PP/PVDF) and are suitable for corrosive liquids, alkalis, toxic, noxious and carcinogenic fluids.

Thanks to the innovative mag drive system, pumps model HPP-HPF reduce the risks of leakage and the maintenance costs. HPP-HPF pumps are useful for low flow and high head applications such as Pilot Plants and Sampling.

### MATERIALS AVAILABLE

- PP, PVDF.
- Materials in contact with the liquid: casing, end cover, internal magnet and rear casing: PP/PVDF; o-ring: EPDM (standard for PP pumps); VITON (standard for PVDF pumps).
- Graphite Stator.
- Rotor shaft: PVDF.

### PERFORMANCES

Max flow 1000 l/h. Max pressure 5 bar.

### TEMPERATURE

PP: max 70°C - PVDF: max 90°C.

## PERFORMANCE CURVES 50HZ - 1450 RPM

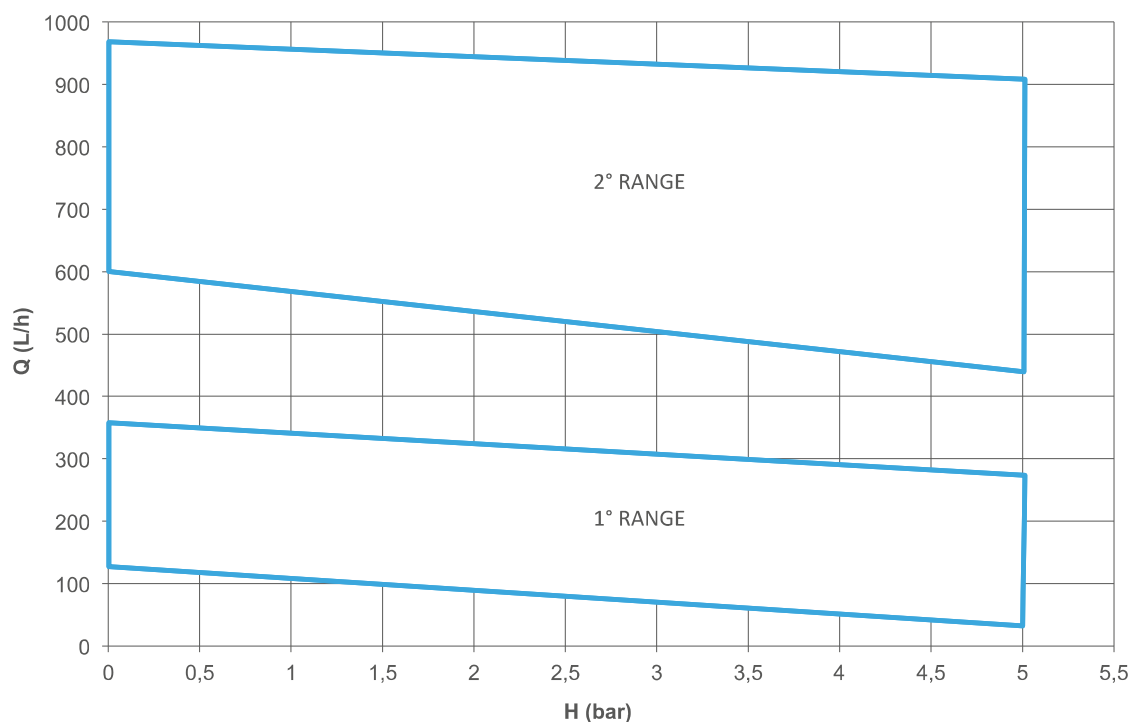

## HPP/HPF TECHNICAL DATA

PUMP SIZE	MATERIAL	Q MAX		H MAX		SUCTION CONNECTION	DISCHARGE CONNECTION	PUMP WEIGHT (KG)		SUITABLE MOTOR POWER (KW) - 1450 rpm	MOTOR FLANGE AND FRAME
		50HZ (l/h)	60HZ (usgpm)	50HZ (bar)	60HZ (PSI)			PP	PVDF		
HPP/HPF 100 1R	PP- PVDF	120	0.66	5	72	3/8" FEMALE	3/8" FEMALE	2.9	3.2	0,37	71 - B3/B5
HPP/HPF 200 1R	PP- PVDF	200	1.1	5	72	3/8" FEMALE	3/8" FEMALE	2.9	3.2	0,37	71 - B3/B5
HPP/HPF 300 1R	PP- PVDF	290	1.5	5	72	3/8" FEMALE	3/8" FEMALE	2.9	3.2	0,37	71 - B3/B5
HPP/HPF 400 1R	PP- PVDF	360	1.85	5	72	3/8" FEMALE	3/8" FEMALE	2.9	3.2	0,37	71 - B3/B5
HPP/HPF 600 2R	PP- PVDF	600	2.5	5	72	1/2" FEMALE	1/2" FEMALE	7	7.5	1,5	90 - B3/B5
HPP/HPF 800 2R	PP- PVDF	800	3	5	72	1/2" FEMALE	1/2" FEMALE	7	7.5	1,5	90 - B3/B5
HPP/HPF 1000 2R	PP- PVDF	990	3.5	5	72	1/2" FEMALE	1/2" FEMALE	7	7.5	1,5	90 - B3/B5

## HPP-HPF 1° RANGE DIMENSIONS

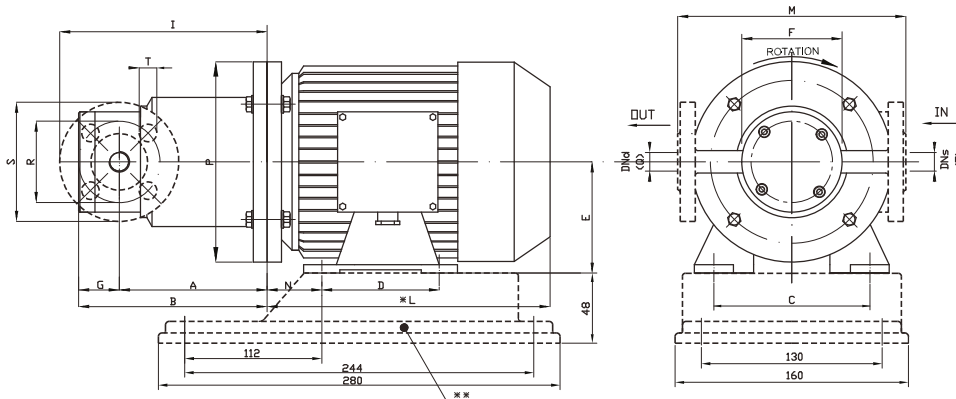

## HPP-HPF 2° RANGE DIMENSIONS

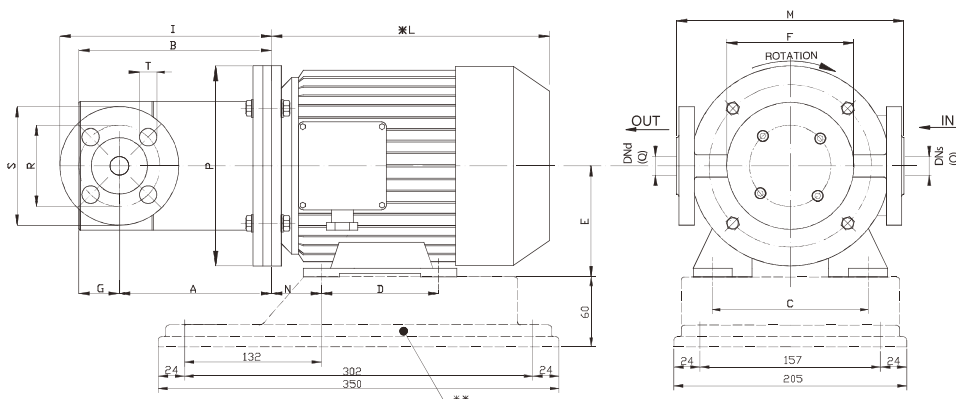

PUMP TYPE	FLANGES DIMENSIONS - mm - DN 15 PN 16				
	R	S	T	DNs	DNd
HPP-HPF 1° RANGE	65	95	14	15	15

PUMP TYPE	FLANGES DIMENSIONS - mm - DN 20 PN 16				
	R	S	T	DNs	DNd
HPP-HPF 2° RANGE	75	105	14	20	20

PUMP TYPE	MOTOR FLANGE B3 - B5	KW	DIMENSIONS - mm -													
			A	B	C	D	E	F	G	I	*L	M	N	O	P	Q
HPP-HPF 1° RANGE	71-4B	0,37	128	164	112	90	71	90	36	175	215	182	45	3/8"G.	160	3/8"G.
HPP-HPF 2° RANGE	90-S2	1,5	169	213	140	100	90	127	44	222	255	218	56	1/2"G.	200	1/2"G.

\* Different according to the manufacturer.

\*\* OPTIONAL UPON REQUEST: Baseplate - Flanges.